

Talon® PIPE SNUG



Code	Colour	Size	Pack Qty
PSB110	Black	110mm	Pack of 1
PSW110	White	110mm	Pack of 1
PSG110	Grey	110mm	Pack of 1
PSOG110	Olive Grey	110mm	Pack of 1

110mm



Installation Instructions

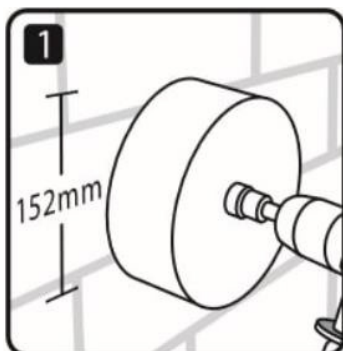

Core drill hole using
standard 152mm core



Insert PipeSnug into
core-drilled hole

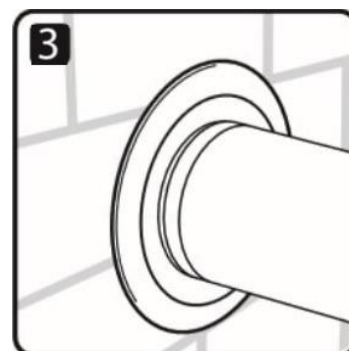

Connect up pipework
in usual way

Talon PIPE SNUG

110mm

- Designed to fit 110mm solvent weld and push-fit fittings - branches, bends, etc (all UK manufacturer brands).
- Complies with Part L Building Regulations.
- Can be used internally and externally.
- For use with solvent weld and push fit soil waste pipe systems.

Core Drill Size	L (mm)	W (mm)	H (mm)	Wgt (kg)	Material (Part 1)	Material (Part 2)	Colours
152mm	182	182	63	0.144	Polypropylene with UV 91872 hindered amine light stabiliser (HALS) additive	TPE (thermoplastic elastomer) with heat and UV stabiliser	Black, White, Grey & Olive Grey

